

Pro series | Dome Camera

IPR2122

Day & Night 1080P HD Dome IR IP Camera

www.meritlilin.com



As with all Pro series cameras, Day & Night 1080P HD vari-focal IR IP camera IPR2122 incorporates Sense up+, a unique technology that successfully delivers stunning video in low-light conditions. Featuring high-efficiency IR-LEDs provide 16 meters of light. Utilizing intelligent image signal processing, AGC control, and 3D Noise Reduction, this model successfully delivers the ultimate low-light image without motion blur. The IPR2122 is capable of producing four independent video streams, different streams can be set for different applications, depending on the individual user requirements.

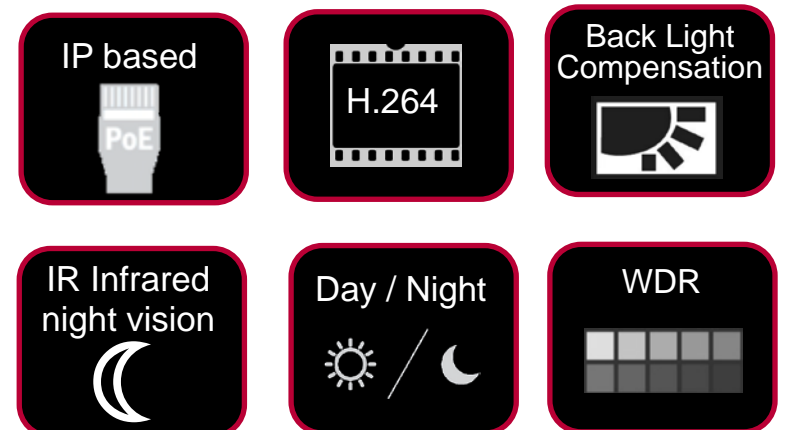

- ▶ Infrared IP dome
- ▶ Wide Dynamic Range
- ▶ Motion, tamper, face detection
- ▶ On-board Infrared lights – The camera can view up to 16 metres at night
- ▶ IR cut filter for day/night operations
- ▶ 1080p video resolution
- ▶ Support Micro SD/SDHC card recording

Dimensions (unit in mm): Ø 120 x 102

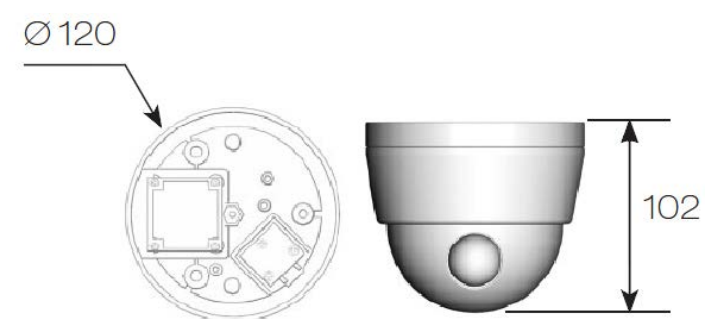
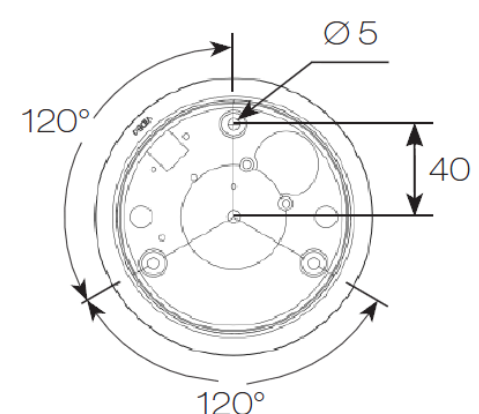

Diagram of mounting holes (unit in mm):



Sense Up+

Deliver outstanding video outputs in poor light conditions without experiencing motion blur. You can see video clearly even during nighttime without sufficient lighting support



Video Security App

Available on Android and iOS – **LILINViewer** app provides security alarm push notification, real-time live viewing, and remote video playback



ONVIF-compliant

Open Network Video Interface Forum (ONVIF) is a standard for physical IP based security products. IPR2122 camera is ONVIF Profile S conformant



Face Detection

Automatically detects a human face



Day and Night Operations via Removal of the IR-cut filter

IPR2122 camera was designed using a mechanical IR cut filter for increased IR sensitivity resulting in improved night time images. The removable IR-cut filter allows day and night operations even in the low lux condition providing outstanding vision



Motion Detection

Detect motion and capture the event. Motion in the selected area will provoke an alert



Tamper Detection

Automatically detects camera sabotage or failure. Detects any attempts to tamper with the camera – partially or completely blocking its lens or field of view

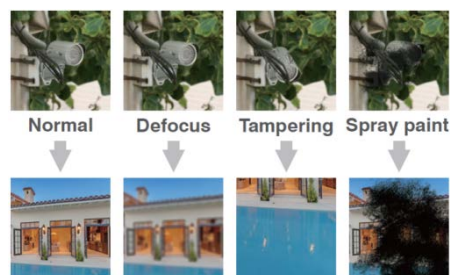

Wide Dynamic Range

An Wide Dynamic Range image is made by taking 3 frames of the same scene and each at different shutter speeds to display details of both the darkest and brightest areas. WDR can extend image visibility under high contrast lighting scenes and improve image quality

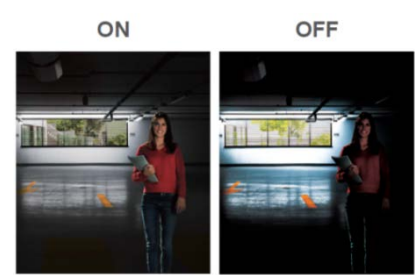

Back Light Compensation

Back Light Compensation (BLC) adjusts the exposure of the entire image to properly expose the subject in the foreground. No matter if the main object is moving toward left, right, upper, lower, or any location in the screen, BLC provides perfect exposure for an object in front of strong back light

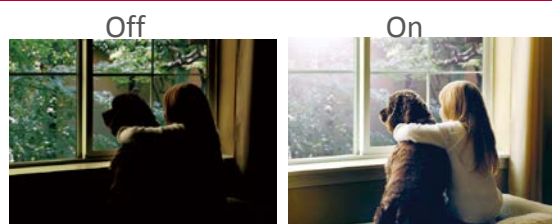

IR Infrared Night Vision

Infrared options with built-in LEDs that are able to see in almost complete darkness, providing clear, detailed video clarity at night-time for round-the-clock video surveillance

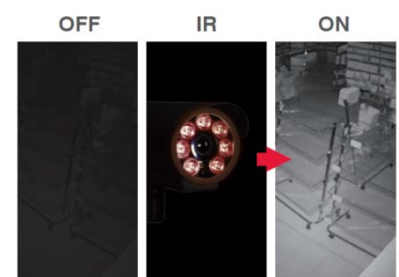

Day & Night 1080P HD Dome IR IP Camera

Video performance & power		
Model#	IPR2122ES4.3	IPR2122ES6
Minimum illumination	0.03 Lux at F1.6 (Low Light Mode), 0 Lux with IR LED ON	0.05 Lux at F1.8 (Low Light Mode), 0 Lux with IR LED ON
Power consumption	DC12V, 7.5W / PoE, 8.5W	
Power supply	DC12V ±10% / PoE (IEEE 802.3af compliant)	

Lens			
Model#		IPR2122ES4.3	IPR2122ES6
Focal length		4mm	6mm
Iris		F1.6	F1.8
Angle of view	H	84.8°	57.6°
	V	45.2°	31.4°
	D	100.6°	67.3

Sensor	
Sensor type	1/2.8" CMOS image sensor
Effective pixels	1984 (H) x 1105 (V) = 2,192,320 (pixel)

Certifications	
CE	Yes
FCC	Yes

PC requirement	
CPU	Intel Pentium 4 1.8GHz or above
OS	Windows 2000 , Windows XP , Windows Vista, Windows 7, Windows 8
RAM	1GB or above ,Independent Display Card
Web browser	Microsoft® Internet Explorer® 6 and later

Mechanical	
Dimensions	Ø120 x 102mm
Weight	450g approx.

Video sreaming	
Video compression	H.264 , Motion JPEG
Streaming	RTP/HTTP, RTP/TCP, RTP/UDP, Multicast
Bitrate	128Kbps~5Mbps Frame rate and bit rate controllable on-the-fly VBR / CBR / GOP supported
IP filter	Yes
RTSP Authentication	On / Off

Network security	
User accounts	10 user accounts available
Access	Multiple user access levels with password protection
Encryption	Base 64 HTTP encryption

Environmental	
Operating temperature	-25°C~+50°C (-13°F~122°F)

Night vision (infrared LED)	
Distance	16m
Peak wavelength	850nm
Beam spread	30°

Video resolution (H x V)		
1080P		1920 x 1080
720P		1280 x 720
D1		720 x 480
CIF		352 X 240
Multiple profile	Profile #1	H.264 : up to 30 FPS @ 1920 x 1080, MJPEG : up to 30 FPS @ 720 x 480
	Profile #2	H.264 : up to 30 FPS @ 1280 x 720, MJPEG : up to 30 FPS @ 352 x 240
	Profile #3	H.264 : up to 30 FPS @ 1920 x 1080, MJPEG : up to 30 FPS @ 1280 x 720
	Profile #4	H.264 : up to 30 FPS @ 720 x 480, MJPEG : up to 15 FPS @ 1920 x 1080

Video functions	
Day/Night (IR-cut filter)	Colour (Day), Monochrome (Night), Auto, Schedule
Scanning system	Progressive scan
White balance	Auto / tungsten / indoor / fluorescents1 / fluorescents2 / outdoor1 / outdoor2
Electronic shutter	1/30(1/25)s~1/8000s
Back light compensation	Off / On
Privacy masking	Off / on (4 zones)
Auto gain control	36 dB variable gain
Image effects	Brightness, Contrast, Hue, Saturation, Sharpness, Mirror, Flip
2D WDR	Off / Auto / x2 / x3 / x4
D/N quality setting	Yes

Integration	
Mobile application	Integrated to LILIN mobile app (LILINViewer) iPhone, iPad, Android support
Video management	ONVIF Profile S LILIN CMX3.6 NAV 1.0 Third party VMS through LILIN HTTP API
Firmware	Firmware upgrade via HTTP Firmware available to download at meritlilin.com

Network	
Ethernet	10Mbps / 100Mbps Base-T, RJ-45
Connectivity	ONVIF Profile S
Users	8 simultaneous users
OSD	Text overly for date, time , and camera name
CPU, Memory	Embedded SoC ARM11, 528MHz, 256MB DDR2, 256MB flash memory
Video display	LILIN Universal ActiveX & LILIN Java Applet
OS	Embedded Linux 2.6.32
Protocols	IPv4, IPv6, TCP, UDP, HTTP, SMTP, NTP, DDNS, UPnP, FTP, ARP, DHCP, PPPoE, DNS, RTSP, RTCP, Telnet, ICMP, IGMP, ONVIF Profile S, SNMP, SIP, Bonjour
Multi IP address	Yes

Main functions	
Sense up	Off / 1 frame / 2 frames / 3 frames / 7 frames
Sense up +	Yes
3D Noise Reduction	Off / 1~32 selectable
Alarm function	Face / tampering / motion detection
	Image upload over FTP and E-mail by face / tampering / motion detection
ePTZ & digital zoom	Yes, ROI is supported
SD Card Recording	Support Micro SD/SDHC card for circular recording (card is not included)
Alarm event	FTP,SMTP, HTTP post, SD card, SAMBA
Alarm weighted mode	Yes